

Sold



3 Triantha Ct, Albany Creek



SPACIOUS FAMILY HOME - GREAT LOCATION

Introducing 3 Triantha Court Albany Creek, a spacious, fresh property nestled in the highly sought-after suburb of Albany Creek.

Location is key, and this property does not disappoint. Situated in a quiet cul-de-sac of Albany Creek, it offers a peaceful lifestyle while remaining conveniently close to a range of amenities. Local schools, parks, shopping centers, and public transport options are all within easy reach, ensuring utmost convenience for daily living.

A truly spacious family home on 600m² of land is just waiting for you to start unpacking with freshly painted interior with new carpet throughout.

🛏 4 🚿 2 🚗 2 📺

600 m²

Price SOLD for
\$955,000

Property Type Residential

Property ID 2113

Land Area 600 m²

Agent Details

Leisa Lowe - 0438 801 298

Office Details

Clontarf

48 Hornibrook Esplanade

Clontarf QLD 4019 Australia

07 3283 6737

This open planned home boasts a functional layout with multiple living and dining areas that come complete with 2 split system air conditioners to relax and enjoy family time, 4 spacious bedrooms, 2 bathrooms, and a 2-car garage, making it an ideal place for growing families.

As you walk into the home, you are greeted by a warm and inviting atmosphere, that catches beautiful breezes and sun filled light throughout.

The open-plan design seamlessly connects the living, dining, kitchen and outdoor area, creating a perfect space for entertaining guests or spending quality time with loved ones.

The kitchen comes fully equipped with an abundance of storage and bench space complete with a breakfast bar, dishwasher, ensuring convenience and efficiency while entertaining guests and family.

The bedrooms are generously sized, all featuring built-in wardrobes, ceiling fans and providing plenty of space for personal belongings.

The master bedroom boasts an ensuite bathroom and walk in robe and has a lovely outlook into the back yard.

If its entertaining space you require look no further, Outside, you will find a spacious yard that offers endless possibilities to create your own oasis. Whether you envision a tranquil garden, a play area for children, or even a pool, this property provides the canvas for you to create your dream.

Additionally, there is a 2-car garage that provides secure

parking for your vehicles, with extra space for storage and direct access into the home.

3 Triantha Court is a blank canvas waiting for you to add your own personal touch and furnishings.

Highlights of the property include –

New Carpet throughout with the interior just freshly painted

Multiple living areas including formal living and dining with additional family living.

Large kitchen hub with breakfast bar comprising of electric oven and cooktop

4 bedrooms in total -Master with ensuite and walk in robe

Tiled family, dining and living area.

Great sized family bathroom with shower and toilet

Fully screened.

Large outdoor Pergola area with space to create your outdoor oasis

Double lock up Garage with extra storage room and direct access into the home

Don't miss the opportunity to make 3 Triantha Court Albany Creek your new home. Contact Leisa Lowe today to arrange an inspection and start envisioning the potential that this remarkable property holds.

Disclaimer: This information is provided for general information purposes only and is based on information provided by the Seller and may be subject to change. No warranty of representation is made as to its accuracy and interested parties should place no reliance on it and should make their own independent enquiries.

The above information provided has been furnished to us by the vendor/s. We have not verified whether or not that information is accurate and do not have any belief in one way or the other in its accuracy. We do not accept any responsibility to any person for its accuracy and do no more than pass it on. All interested parties should make and rely upon their own inquiries in order to determine whether or not this information is in fact accurate.



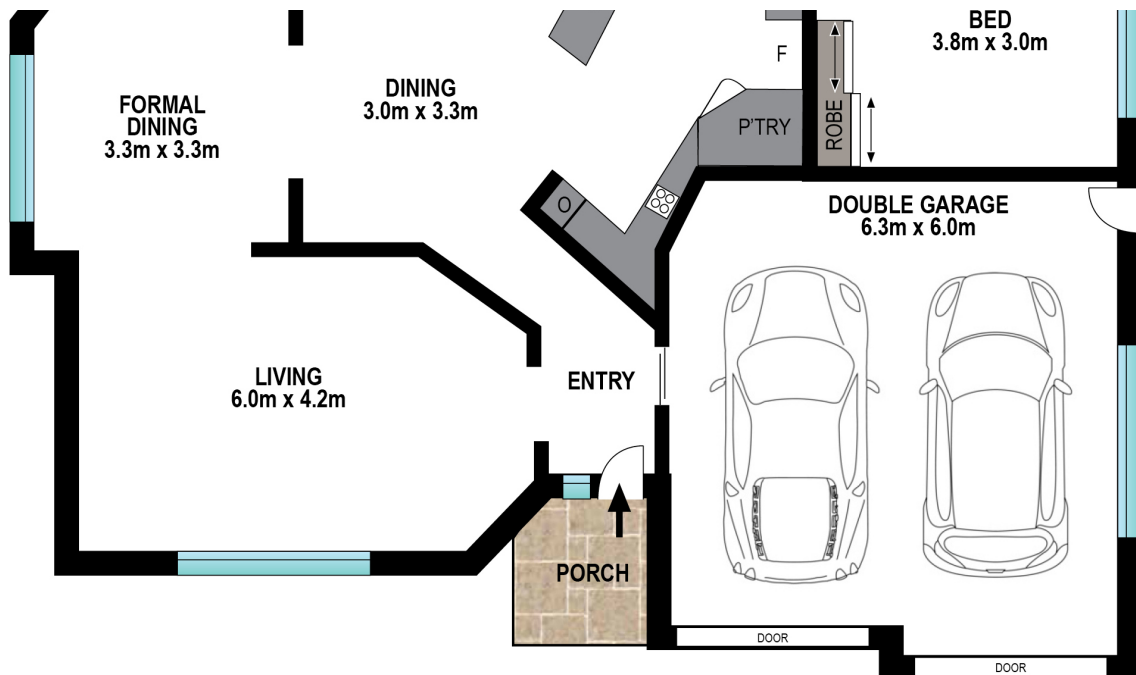

Scale in meters. Indicative only. Dimensions are approximate. All information contained herein is gathered from sources we believe to be reliable. However we cannot guarantee its accuracy and interested persons should rely on their own enquiries.

3 Triantha Ct, Albany Creek