

Sold



2, 88 Mcpherson Street, Kippa-ring



## GROUND FLOOR, SINGLE LEVEL, WALK TO EVERYTHING

This well positioned, two-bedroom, single level, ground floor unit is conveniently located within walking distance to almost everything. Cross over the road to the Redcliffe Leagues Club and the Dolphins Central Shopping Centre and just a short walk in the other direction is the Kippa-Ring Shopping Centre and the Kippa-Ring Train Station. With public transport on your doorstep, commuting to the shops, cafes and amenities at Redcliffe, or the Westfields Shopping Centre at North Lakes is a breeze.

This tidy, well-presented home is in a small block of 6 low maintenance units, with low body corporate fees. Two good sized bedrooms, great living space, separate toilet, bathroom, and laundry this is a great find.

 2  1  1

**Price** SOLD for  
\$368,000

**Property Type** Residential

**Property ID** 1968

### Agent Details

Rachele Jones - 0432 834  
733

### Office Details

Clontarf  
48 Hornibrook Esplanade  
Clontarf QLD 4019 Australia  
07 3283 6737

This home features:



- Entry via a private courtyard
- Spacious open plan, air-conditioned lounge, dining, and kitchen to provide comfortable living.
- Good practical kitchen with upright stove, decent storage and functional bench space. There is also a breakfast bar and rangehood.
- Two bedrooms with built in robes. Both rooms have doors out to access the courtyard and security screens.
- Bathroom with bath, vanity, and shower. The toilet is separate.
- Laundry with tub and access to backyard/courtyard
- The yard is currently shared with the neighbouring unit, but there is the option to enclose part of this for your own private use. With body corporate approval
- Internal access from the single car garage. The garage has a remote-control door and space to allow for storage at the end.
- Security Screens on the doors and windows
- Very reasonable body corporate fees in a complex with mostly owner occupiers

The current owner has loved living here but due to a change of circumstances, is keen and motivated to move onto the next stage of life. Properties in locations like this don't come along too often, so you will need to move quickly if you want to make this your next home.

All information contained herein is gathered from sources we believe to be reliable. However, we cannot guarantee its accuracy and interested persons should rely on their own enquiries.

The above information provided has been furnished to us by the vendor/s. We have not verified whether or not that information is accurate and do not have any belief in one way or the other in its accuracy. We do not accept any responsibility to any person for its accuracy and do no more than pass it on. All interested parties should make and rely upon their own inquiries in order to determine whether or not this information is in fact accurate.

Internal Living Area : 91 Sqm  
External Living Area : 11 Sqm  
Total Living Area : 102 Sqm

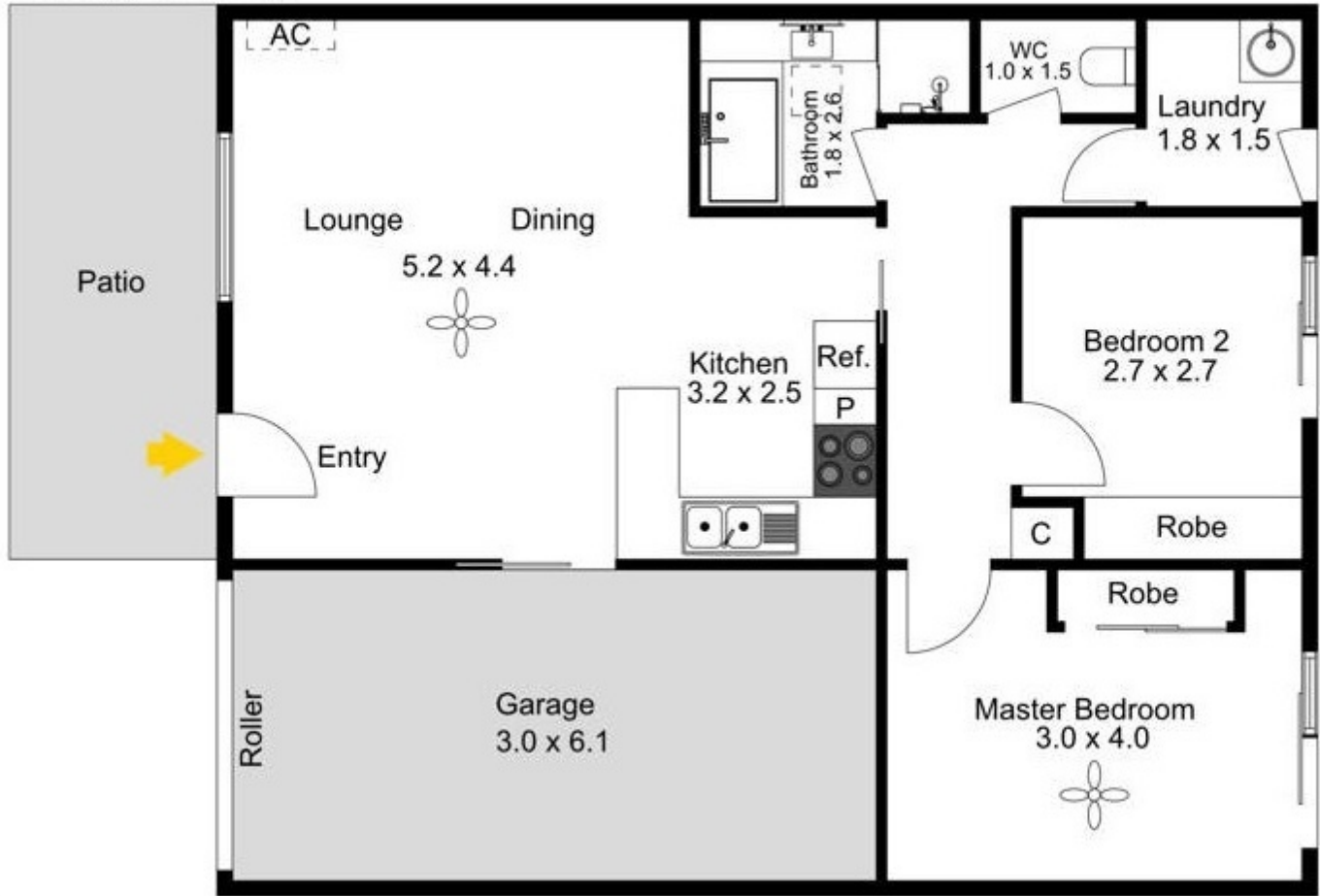

Produced by DIAKRIT